

User guide

AX'Up Air

Table des matières

1	Revisions	3
2	Product description	4
3	Start-up guide for BLE mode.....	5
3.1	Connection Windows Bluetooth Mode	7
3.2	Connection Android Bluetooth Mode.....	8
4	Description of the HMI, different modes of operation.....	9
5	Start-up guide For USB mode	10
5.1	USB-C to PC	10
5.2	Connect USB-C to C (Android)	11
6	AX'Up Windows demo App description	12
7	AX'Up Android demo App description	13
8	Firmware updater.....	14
9	Operating range and technical data	15
10	Safety instruction.....	15
10.1	laser equipment	15
10.2	Battery	15
10.3	Power supply	16

1 Revisions

Description	Date	Version	Auteur	Check
First release	2021/07/08	1.0	LDU	
	2022/03/11	1.4	AT	
Add laser class 1 information	2022/06/01	1.5	LDU	AT
Add UHF band EU and power RF	25/07/22	1.6	AT	LDU
Update for Bluetooth version	12/04/2023	1.7	LDU/DGA	AT
Add symbol ISO 7000 (care in use)	11/05/2023	1.8	AT	
Update Mode charge Battery +10°C to +37°C and Mode Discharge -20°C to +50°C	21/06/2023	1.9		
Update IHM	13/07/2023	2.0	AT	

2 Product description

AX'Up Air is a UHF and 2D reader using USB and BLE communication.

Working modes:

- keyboard emulator in BLE and USB
- Virtual com port in USB

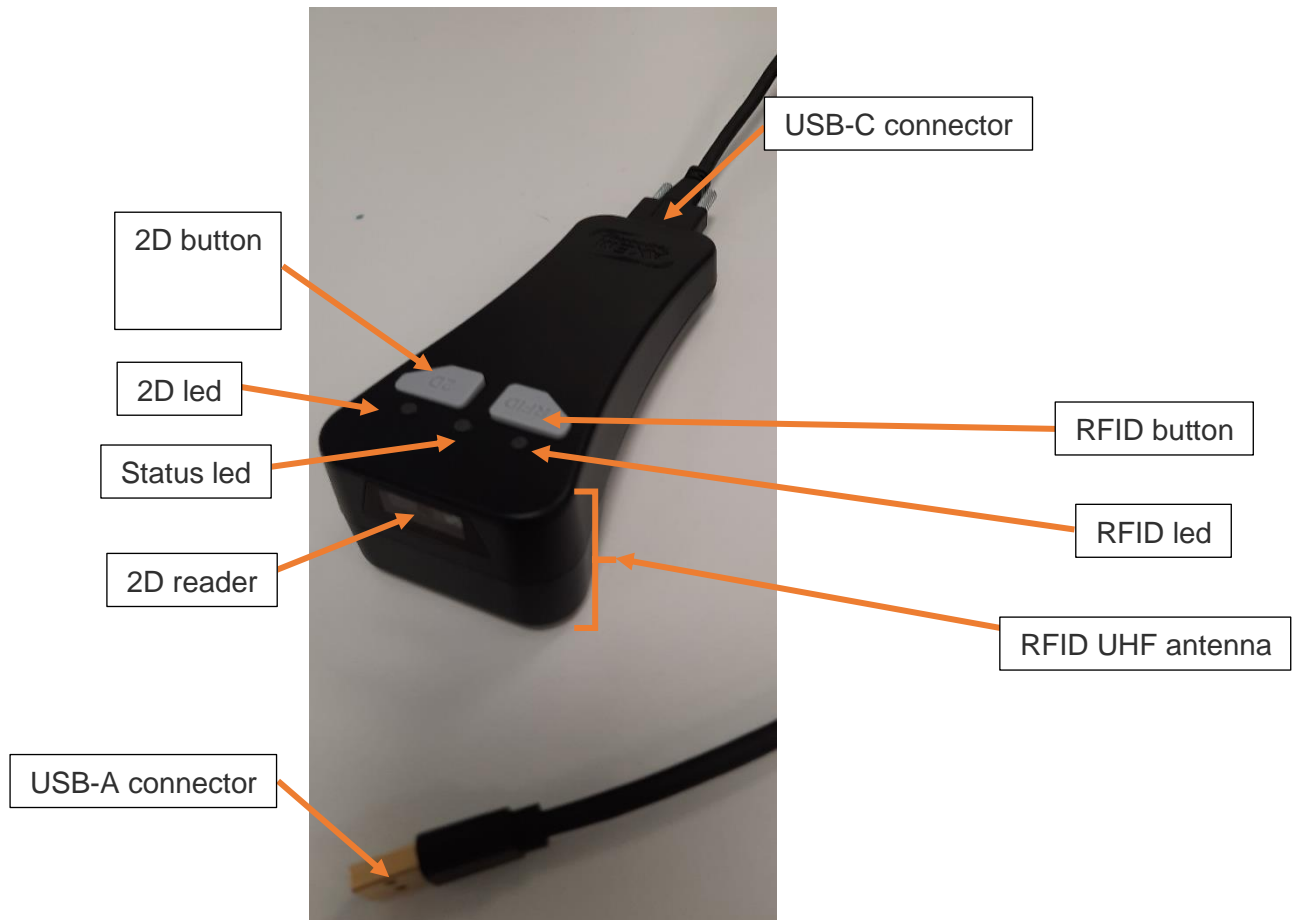















3 Start-up guide for BLE mode

First you have to know the name of the device to connect it in Bluetooth mode with Android or Windows. Usually , it is located on the label on the back of the shell. If is not the case, it can be recovered.



For this we connect the device to the PC and we launch following application “Full Demo Apps” in the repertory :

SDK_AXEM_WINDOWS_V2.1.2.0\SDK_AXEM_WINDOWS_V2.1.2.0\SDK_AXEM_WINDOWS_V2.1.2.0\SDK_AXEM_WINDOWS_V2.1.2.0\

 AXEM_API.dll	24/01/2023 01:44	Extension de l'app...	27 Ko
 AXEM_API.pdb	24/01/2023 01:44	Program Debug D...	24 Ko
 AXUP_Lib.dll	24/01/2023 01:44	Extension de l'app...	55 Ko
 AXUP_Lib.pdb	24/01/2023 01:44	Program Debug D...	122 Ko
 AX'UpQuickDemo	24/01/2023 01:44	Application	213 Ko
 AX'UpQuickDemo.pdb	24/01/2023 01:44	Program Debug D...	46 Ko
 ConsoleAXUpDemo	24/01/2023 01:44	Application	7 Ko
 ConsoleAXUpDemo.pdb	24/01/2023 01:44	Program Debug D...	22 Ko
 Full Demo app	24/01/2023 01:52	Application	993 Ko
 Full Demo app.pdb	24/01/2023 01:52	Program Debug D...	192 Ko
 M2X00Lib.dll	24/01/2023 01:44	Extension de l'app...	22 Ko
 M2X00Lib.pdb	24/01/2023 01:44	Program Debug D...	70 Ko
 USBClassLibrary.dll	24/01/2023 01:44	Extension de l'app...	18 Ko
 USBClassLibrary.pdb	24/01/2023 01:44	Program Debug D...	18 Ko

Start the application and then select the corresponding COM port, then click connect.



Then the device will give the serial port number and the name of the device, which we will use to connect it via Bluetooth.



3.1 Connection Windows Bluetooth Mode

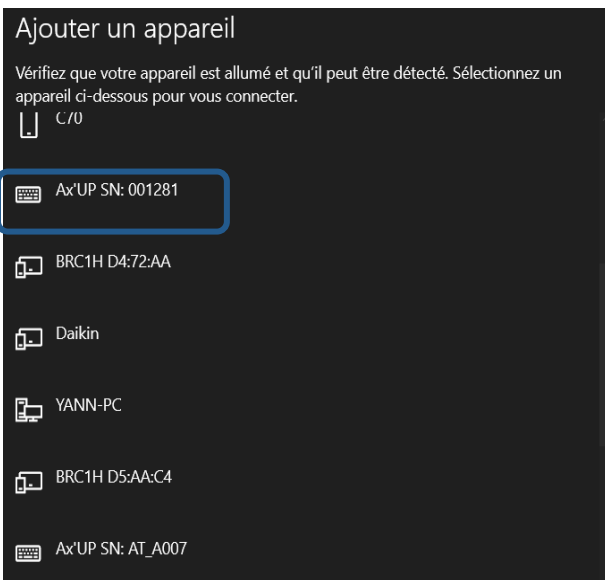
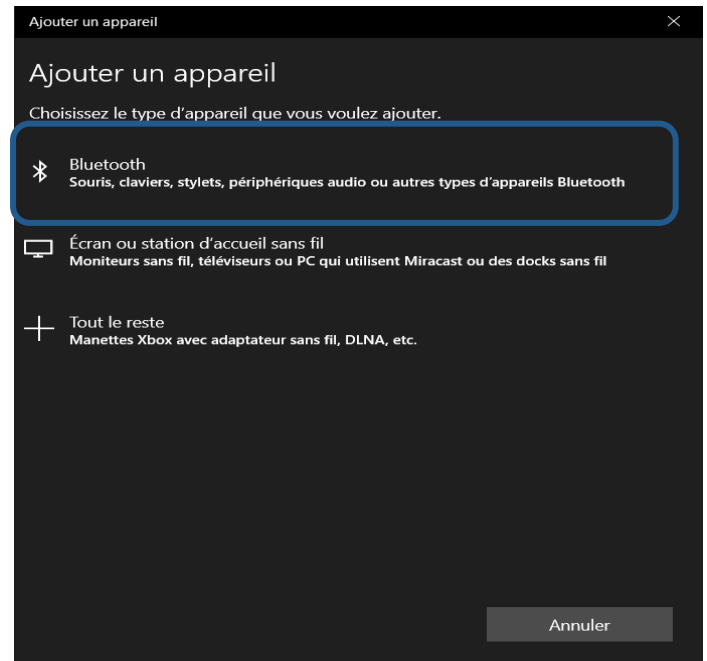
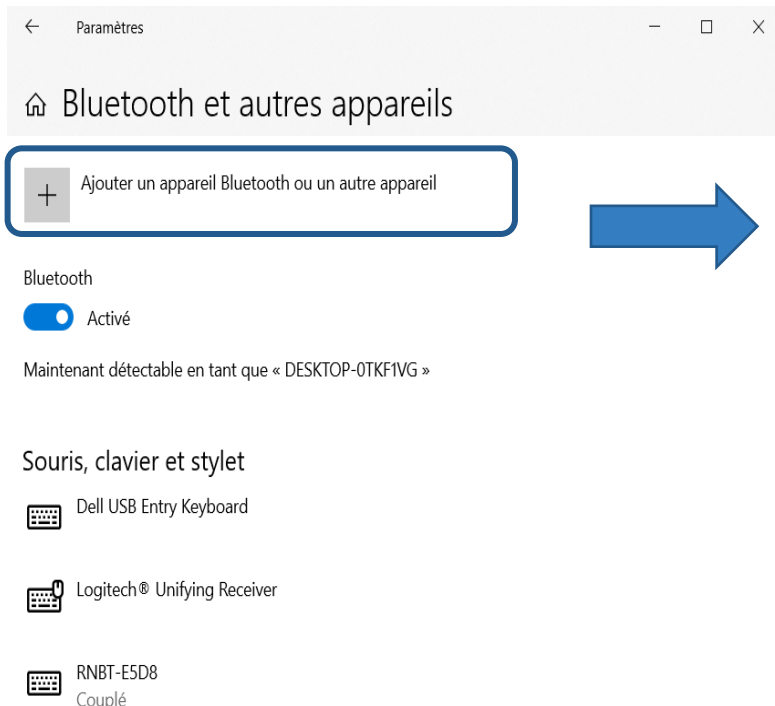

This is important to know: if the AX'UP has been connected previously to another device via Bluetooth, it will not be able to find it elsewhere, so it is imperative to dissociate from the old device and reset the Ax'Up (press about 15 seconds on the RFID and 2D key at the same time), then we can associate with the new device !

3.2 Connection Android Bluetooth Mode

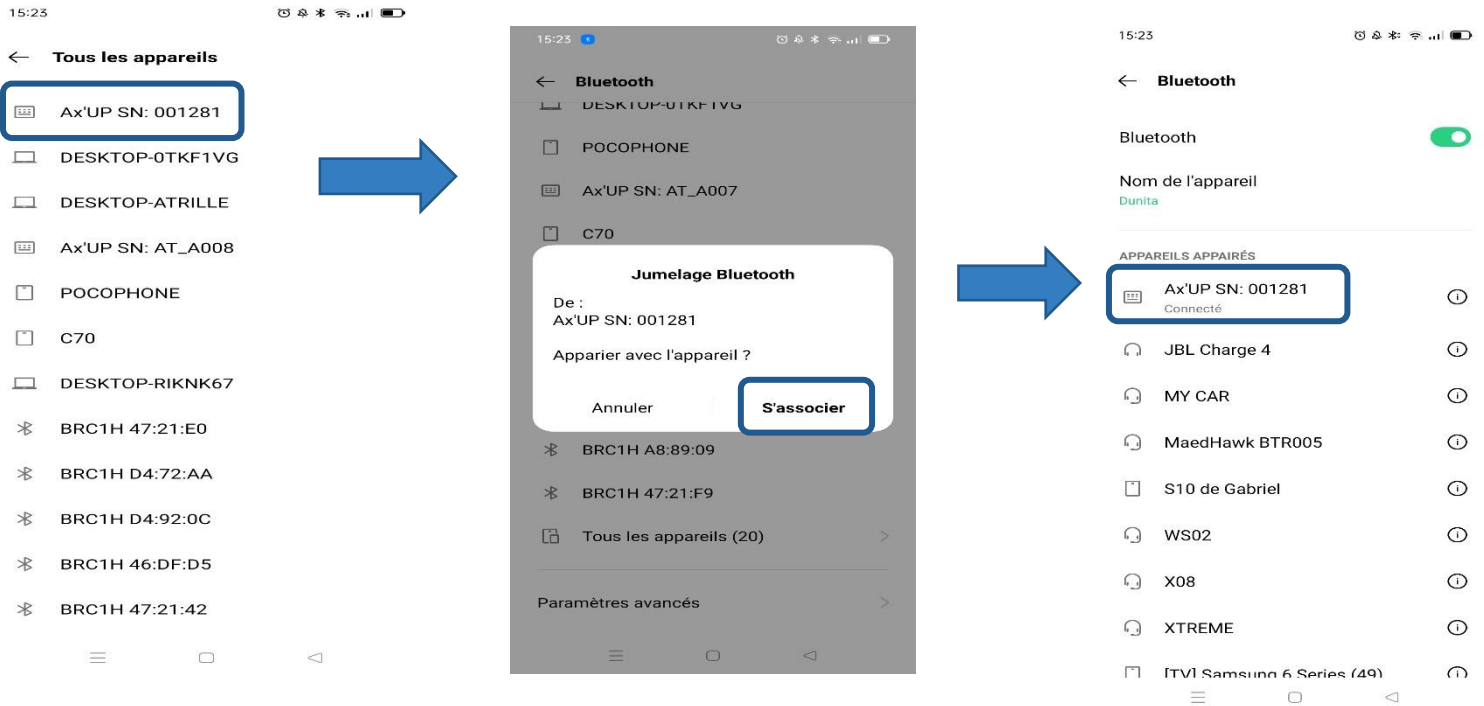

Important to know : if your Android device is not in Azerty keyboard mode, you must make a small configuration to be able to read correctly the 2D and UHF in physical keyboard mode.

- 1- Go to settings in the keyboard and input method part
- 2- Press physical keyboard and change the keyboard layout by putting Azerty or French keyboard

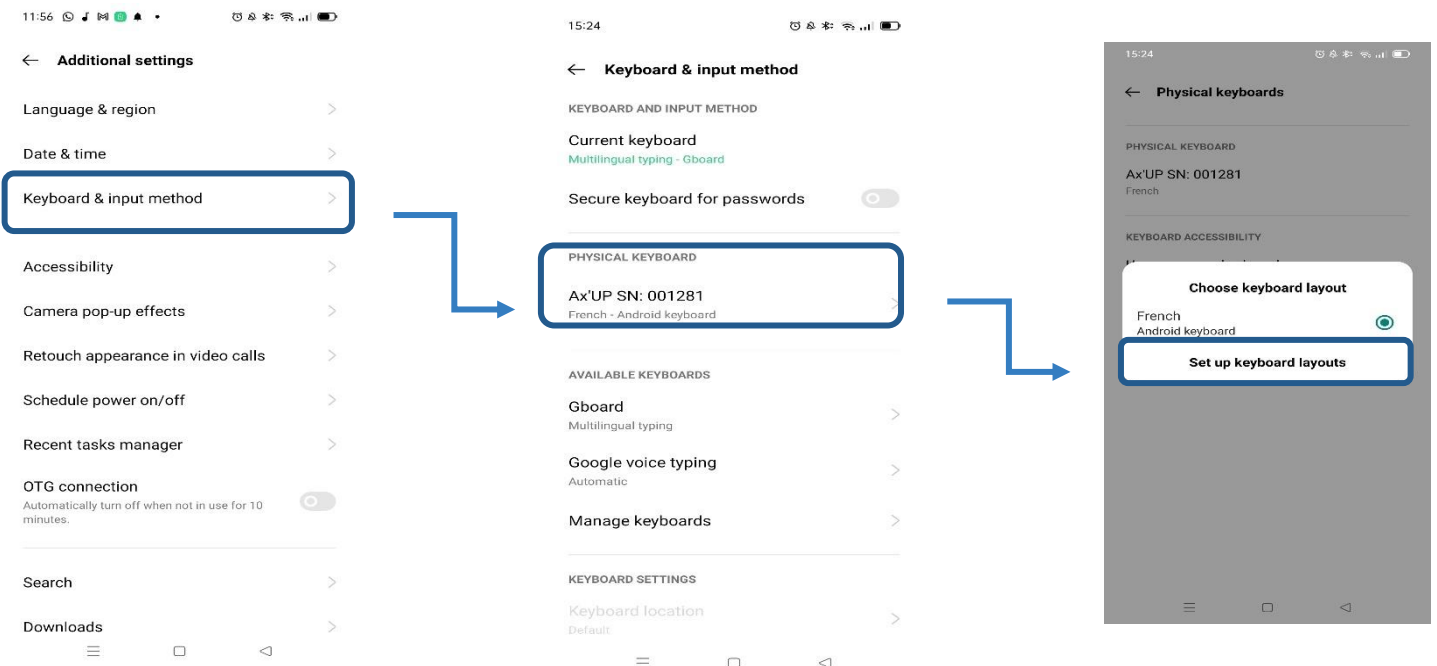

4 Description of the HMI, different modes of operation



LED status



Power On / Power off
Press the 2 buttons for 4 seconds.



Reset
Press the 2 buttons for 14 seconds.



Scan

Press either the RFID button or 2D button. A beep sounds and the RFID/2D LED is green when reading is successful.



Green
Successful scan



Red
Scan failure

5 Start-up guide For USB mode

5.1 USB-C to PC

1. Connect and screw the USB-C cable to the device:

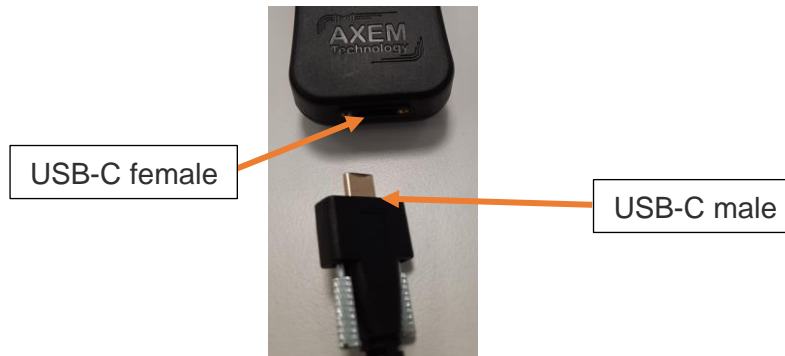

The connector can be screwed by hand or with a screwdriver:



Don't need to squeeze too much: it's well connected as soon as the spanner adjuster is in contact with the connector.



2. Connect the USB-A side of the cable to the device

- The **status led** will **blink blue** = **Connection is ok.**
- Then the **status led** will remain **red** until **initialization is done.**
- **2D led** and **RFID led** will **blink green** = The **2D and RFID initialization are in running**
- Then the **status led** will turn **green** = There was no failure : reader is ready to use.



5.2 Connect USB-C to C (Android)

To load the Ax'up with an android device, go to settings, then to additional settings and activate the OTG connection.

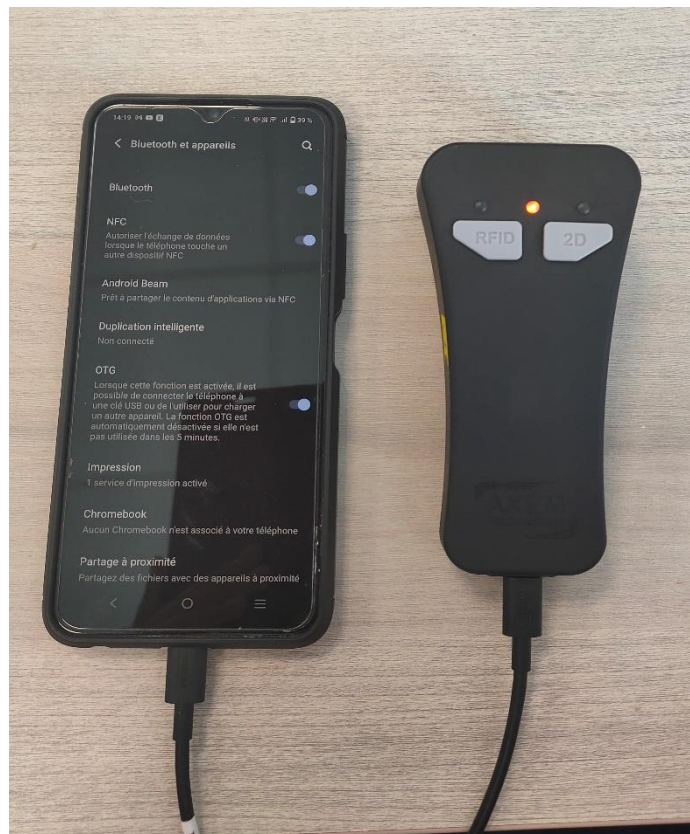
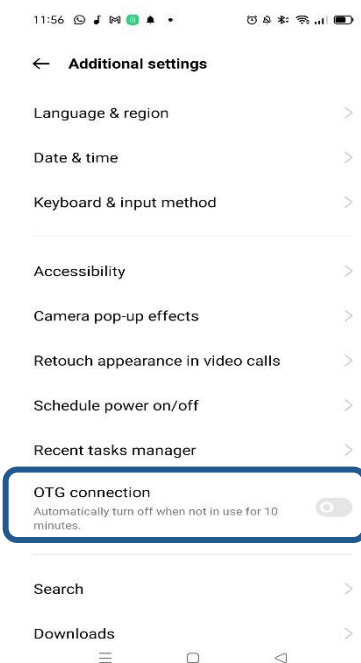

6 AX'Up Windows demo App description

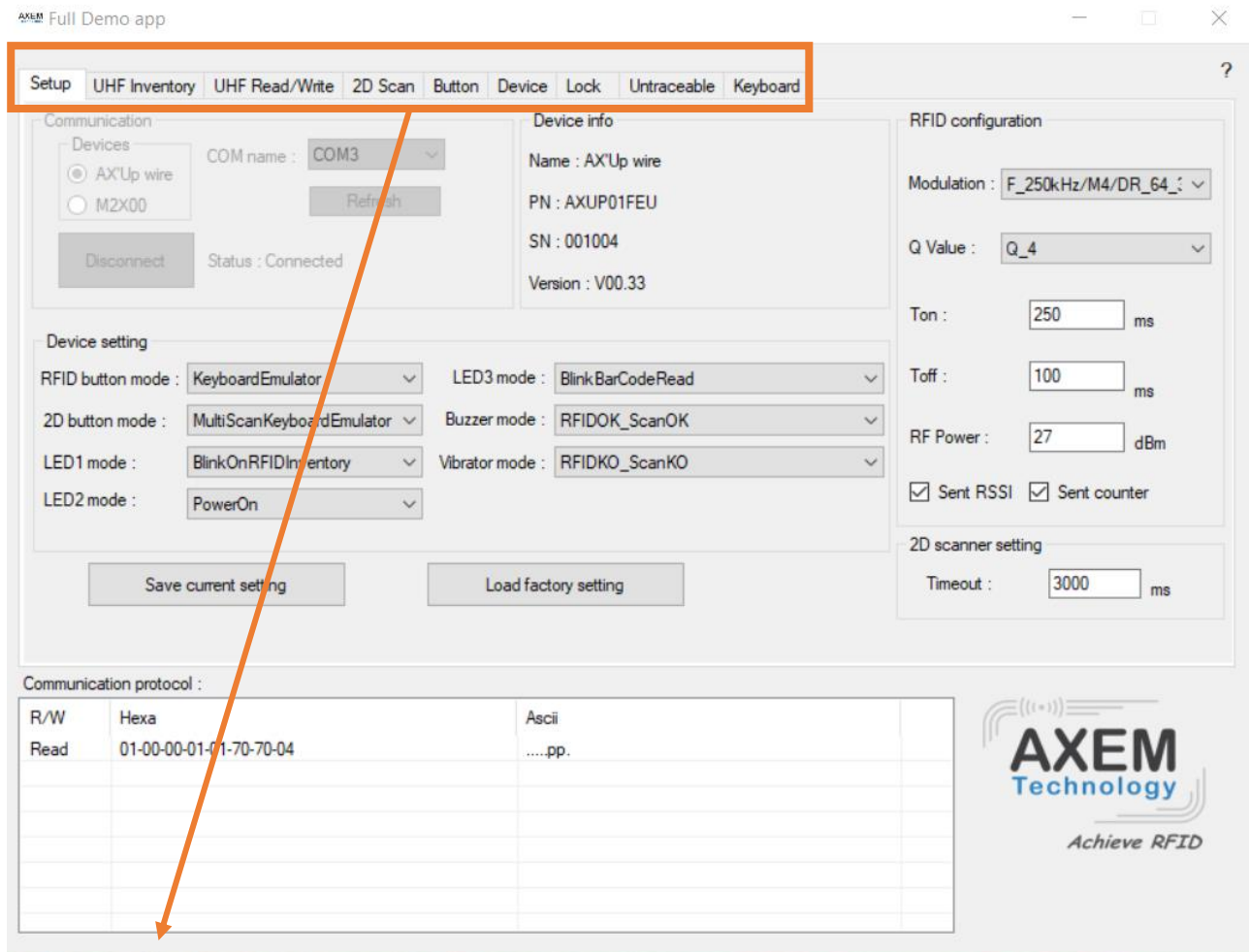

- SETUP : All setting are available in this tag
- UHF INVENTORY : Basic RFID actions (read EPCs) from demo app
- UHF READ/WRITE : Reading and writing UHF tags memory.
- 2D SCAN : Barcodes scanning from demo app
- BUTTON : UHF and barcodes actions from buttons of the device
- DEVICE : Master control settings for the HMI (Human machine interface)
- LOCK : RFID lock and kill actions
- Untraceable : RFID Untraceable settings
- Keyboard : Keyboard emulator settings

7 AX'Up Android demo App description

The android demo app allow RFID and Bacoode readings. In the RFID menu it is possible to do read/write, lock and untraceable operations on a tag with a long click on its EPC code.

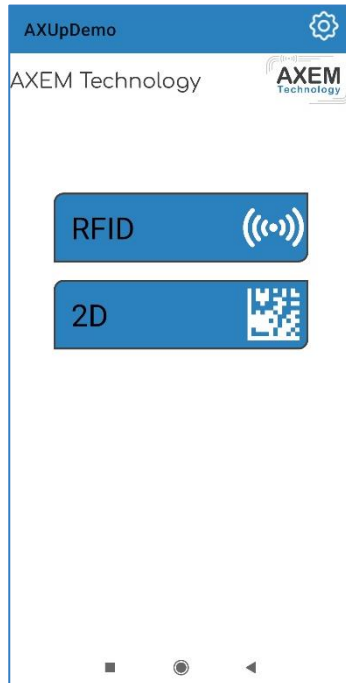

Main menu

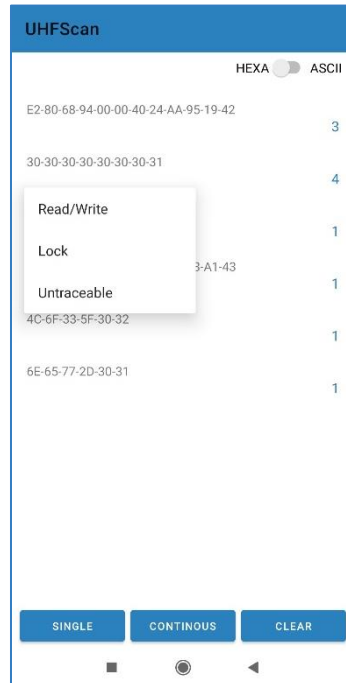

RFID menu

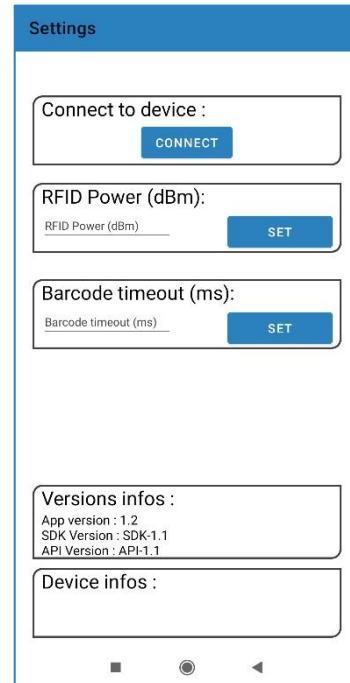

Setting menu

8 Firmware updaters

If the reader firmware must be updated AXEM would provide a .bin file. A software is provided to make it possible:

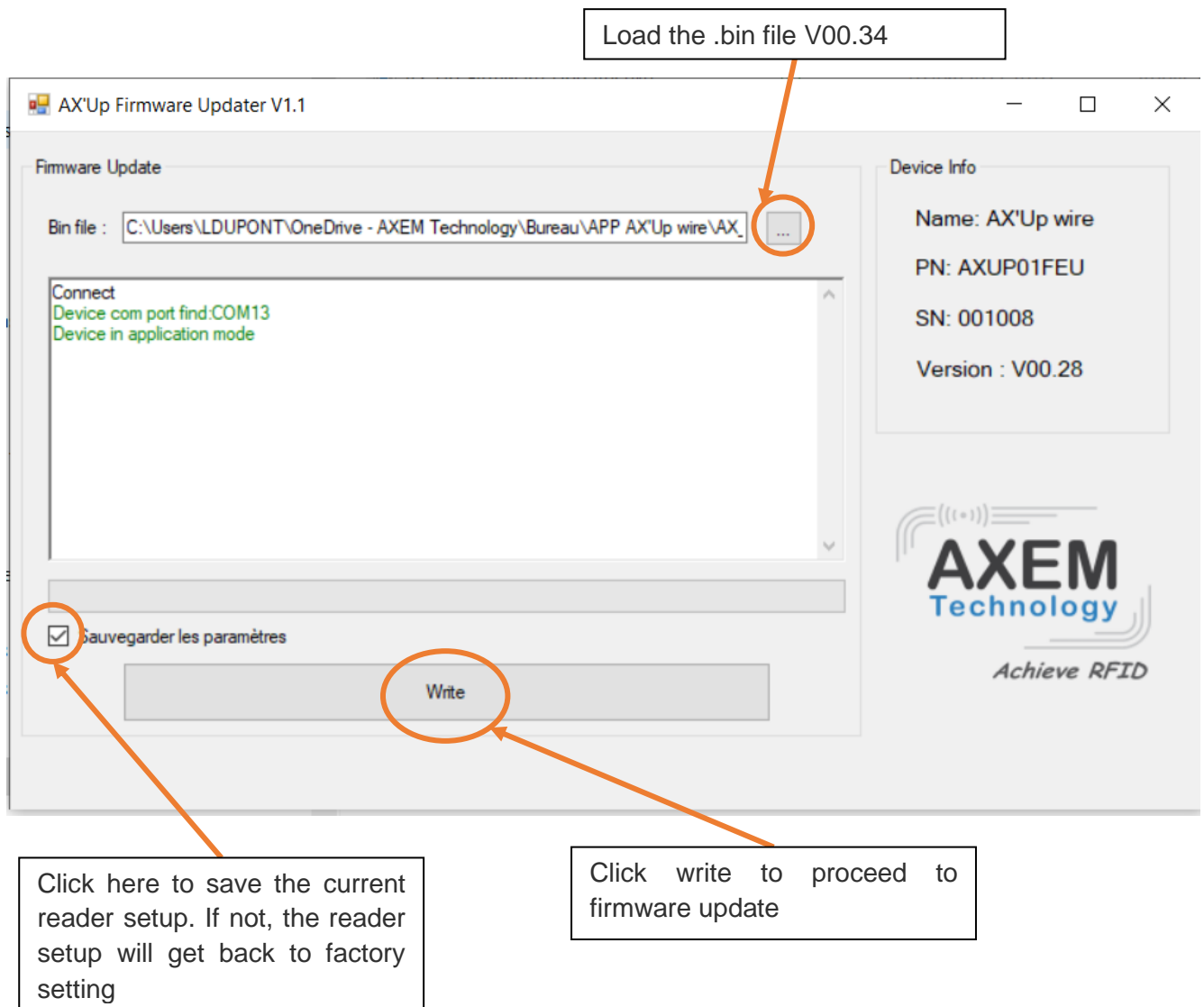

The screenshot shows the 'AX'Up Firmware Updater V1.1' application window. The interface is divided into several sections:

- Bin file:** A text box containing the path 'C:\Users\LDUPONT\OneDrive - AXEM Technology\Bureau\APP AX'Up wire\AX_...' with a browse button (three dots) circled in orange. A callout box above it says 'Load the .bin file V00.34'.
- Connect:** A text area showing 'Device com port find.COM13' and 'Device in application mode'.
- Device Info:** A panel on the right showing 'Name: AX'Up wire', 'PN: AXUP01FEU', 'SN: 001008', and 'Version : V00.28'.
- AXEM Technology logo:** Located at the bottom right of the interface.
- Save parameters:** A checkbox labeled 'sauvegarder les paramètres' is checked and circled in orange. A callout box below it says 'Click here to save the current reader setup. If not, the reader setup will get back to factory setting'.
- Write:** A 'Write' button is circled in orange. A callout box below it says 'Click write to proceed to firmware update'.

9 Operating range and technical data

- UHF EU band, Channels 4, 7, 10, 13 (865.70Mhz / 866.30Mhz / 866.90Mhz / 867.50Mhz).
- Maximum power UHF: +27dBm
- Temperature operating discharge: -20°C to +50°C.
- Temperature storage: -40°C to +70°C.
- Temperature Charging mode: +10°C to +37°C
- IP 54.
- CE / RoHS.
- Product weight: 200gr.
- Battery capacity: 1000mAh

10 Safety instruction

10.1 laser equipment

- The product use white Lamp, as case with any brightness source, as the sun, tests following IEC 62471 has been done to demonstrate that the engine is safe for its intended application under usage conditions. However, the user should avoid looking into beam.
- The product uses a laser diode to form intuitive aiming aid. This Laser diode has been tested and found to comply with the limits for a **Class 1 laser product**, pursuant to Safety of laser products - Part 1: Equipment classification and requirements of IEC 60825-1:2014. A class 1 laser is safe under all conditions of normal use. However, the user should avoid looking into beam. Class 1 laser devices are not considered dangerous, but only if they are used for their intended purpose.



10.2 Battery

The product includes a rechargeable Lithium polymer battery equipment.

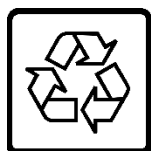

Li-Pol 3,7V 3,7Wh



A caution is necessary when operating the device. Do not open, crush, disassemble or dispose of in fire.

10.3 Power supply

 : Applied a direct current (DC): 600mA and voltage 5V0.